



LINEAR MOTION CONTROL

Customer Notice



Rod Lock Series Spacer Adaptation for Cylinders

A spacer is included with this assembly for use when mating to pneumatic cylinders. Not all cylinders require this spacer. To determine if the assembly requires a spacer, measure the length of the male pilot extending from the face of the cylinder (dimension G).

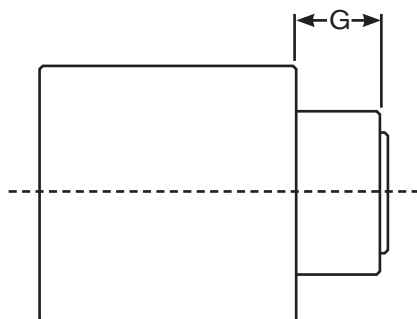

Spacer is required when pilot length is greater than listed below.

Cylinder Size	Pilot Length (G)
40 mm	21.50 mm
50 mm	28.30 mm
63 mm	28.90 mm
125 mm	48.00 mm

If a spacer is required, mount the spacer between the Rod Lock and the Cylinder.

In accordance with Nexen's established policy of constant product improvement, the specifications contained in this manual are subject to change without notice. Technical data listed in this manual are based on the latest information available at the time of printing and are also subject to change without notice.



Nexen Group, Inc.
560 Oak Grove Parkway
Vadnais Heights, MN 55127

800.843.7445
Fax: 651.286.1099
www.nexengroup.com