



## DPS60A - DUAL OUTPUT RANGE SENSOR WITH COUPLING

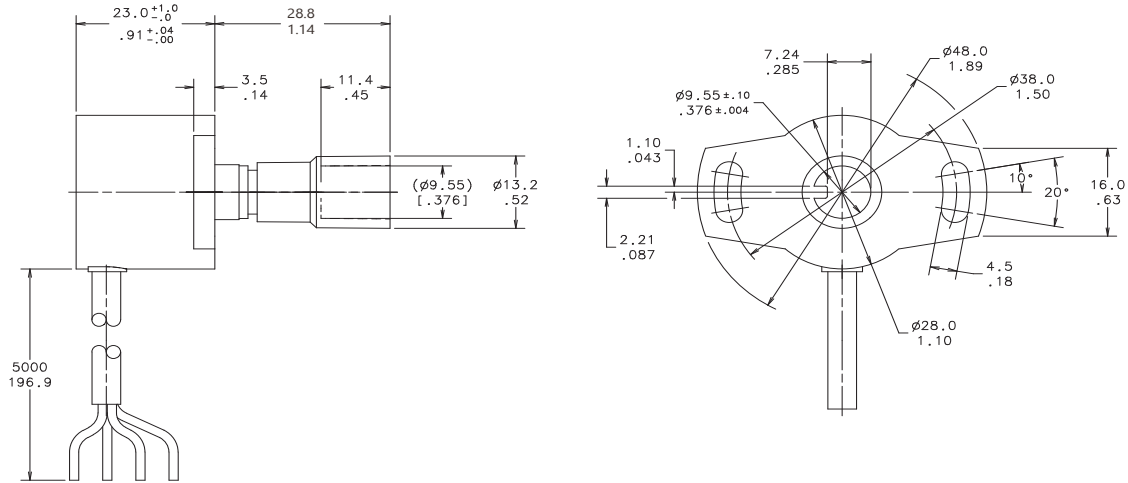

Figure 1 DPS60A Dimensions

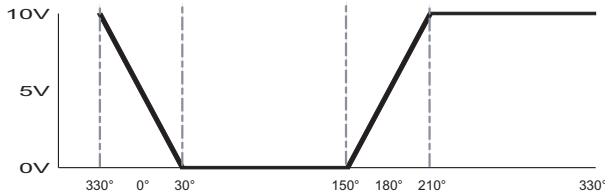

Figure 2 Sensor Output

This rotary sensor has two active 60 degree ranges with opposing slopes, as shown in Figure 2 and Figure 3. The sensor can be configured to sweep 0-10V in both the clockwise and counter-clockwise direction. For counter-clockwise rotation, mount the sensor as shown in Figure 3 for the electrically zero position. For clockwise rotation, rotate the sensor mounting 180 degrees.

## Specifications

	DPS60A
Product Number	964519
Supply Voltage	24 ± 6 VDC
Output Voltage	0-10, 10-0 VCD @ maximum angular rotation, dual output range
Reverse Polarity Protection	-30 VDC maximum
Temperature	-40°F [-40°C] to 185°F [85°C]
Enclosure	IP65
Accuracy	± 1
Angular Rotation	+/- 60° maximum

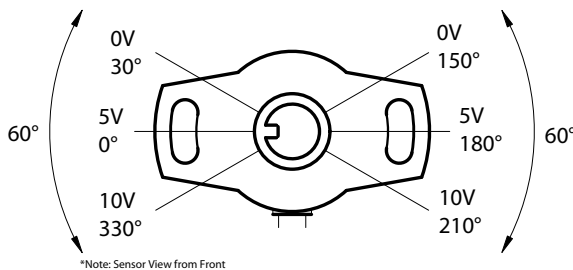

Figure 3 Dual Output Range