

## “Web Controls”

# SMALL WEB GUIDE INSTALLATION AND MAINTENANCE INSTRUCTIONS



Read this manual carefully, making full use of its explanations and instructions. The “Know How” of safe, continuous, trouble-free operation depends on the degree of your understanding of the system and your willingness to keep all components in proper operating condition. Pay particular attention to all NOTES, CAUTIONS, and WARNINGS to avoid the risk of personal injury or property damage. It is important to understand that these NOTES, CAUTIONS, and WARNINGS are not exhaustive. Nexen cannot possibly know or evaluate all conceivable methods in which service may be performed, or the possible hazardous consequences of each method. Accordingly, anyone who uses a procedure that is not recommended by Nexen must first satisfy themselves that neither their safety or the safety of the product will be jeopardized by the service method selected.

## CONTENTS

INSTALLATION -----	2
ELECTRICAL CONNECTIONS -----	2
LIMIT SWITCH AND CENTERING SWITCH ADJUSTMENT -----	3
REPLACEMENT PARTS -----	4
PARTS LIST -----	5

## INSTALLATION

1. Position the Web Guide as close as possible to the critical area to which the web is being guided. Any rolls between the lead out roll **C** and the critical area will detract from guiding accuracy (See Figure 1).
2. Find the web path to be used (See Figure 1).
  - a. Lead in roll **A** and lead out roll **C** are customer provided.
  - b. The web must travel through the Web Guide in the direction of the arrow on the side of the Web Guide.
  - c. Web lead in distance (**A** to **B**) and lead out distance (**B** to **C**) must be at least  $1\frac{1}{2}$  times the web width.

### NOTE

**$1\frac{3}{4}$  times the web width is the recommended distance between web lead in and lead out.**

- d. Ensure that the Web Guide rolls **B** are parallel to the lead in roll **A** and the lead out roll **C** when the Web Guide is in its mid-travel or centered position.
3. Mount the Web Guide to the machine.

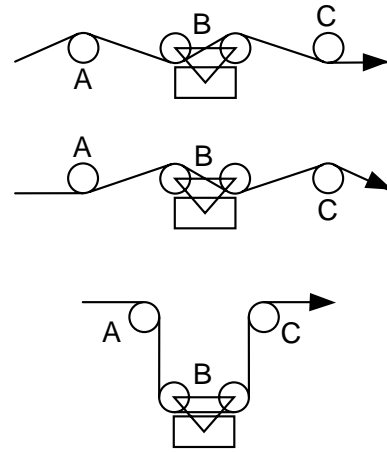

FIGURE 1

## ELECTRICAL CONNECTIONS

Interconnecting cable 30243 is available to connect the customer supplied Controller to the Web Guide. An 18 AWG shielded cable makes the connections between the customer supplied Controller and the Motor, Centering Switches, and Limit Switches. **P1** mates with connector **J1** mounted on the Web Guide (See Figure 2).

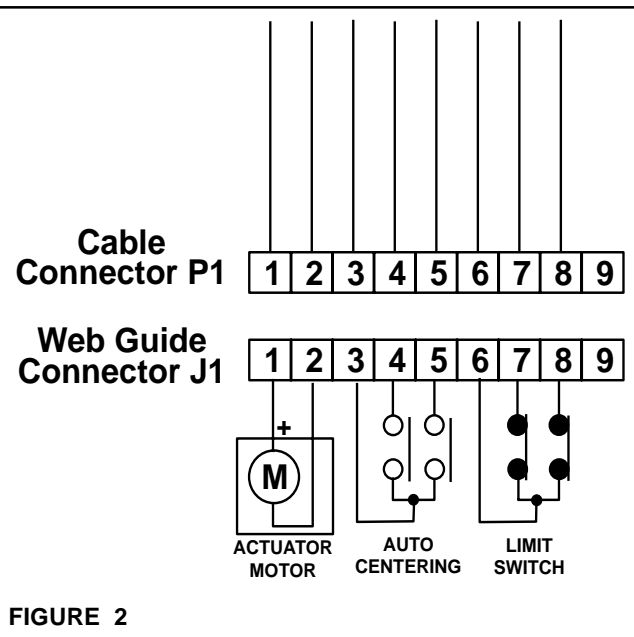

FIGURE 2

# LIMIT SWITCH AND CENTERING SWITCH ADJUSTMENT

## LIMIT SWITCH ADJUSTMENT

### CAUTION

Limit Switches must be adjusted to interrupt movement before contact is made with a physical obstruction or stop. Failure to do so will damage the Controller or surrounding equipment. If there are no obstructions, the Limit Switches may be left in their factory set positions for maximum travel.

1. Loosen the Limit Switch Brackets and slide them to their fully outward position (See Figure 3).
2. Turn the Controller **ON** and set it to manual control mode.
3. Using the Controller switches to actuate the motor, move the Slide Plate in one direction until the desired end of travel is reached (See Figure 3).
4. Connect a voltmeter across Terminals 1 and 2 of one Limit Switch (See Figure 3).
5. Slide the respective Limit Switch Bracket towards the Slide Plate until the Limit Switch makes contact with the Slide Plate and the voltmeter reads  $\pm$  (plus or minus) 5 volts.
6. Tighten the Pan Head Screws holding the Limit Switch Bracket (See Figure 3).
7. Repeat Steps 3 through 6 for the second Limit Switch (See Figure 3).
8. Turn the Controller **OFF**.

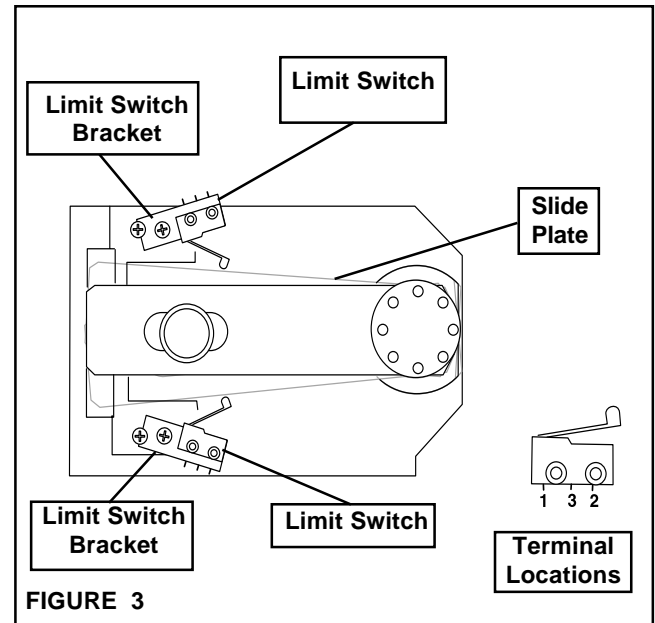

FIGURE 3

## CENTERING LIMIT SWITCH ADJUSTMENT

### NOTE

The Centering Limit Switches have been set at the factory. The Centering Limit Switch adjustment should be performed only if the Centering Limit Switch settings have been changed to settings other than the factory settings.

1. Turn the Controller **ON** and set it to manual control mode.
2. Using the Controller switches to actuate the motor, move the Slide Plate in either direction until it is centered on the base (See Figure 4).
3. Turn the Controller **OFF** and disconnect Web Guide from the Controller.
4. Connect an ohmmeter across Terminals 1 and 3 of one Centering Limit Switch (See Figure 4).

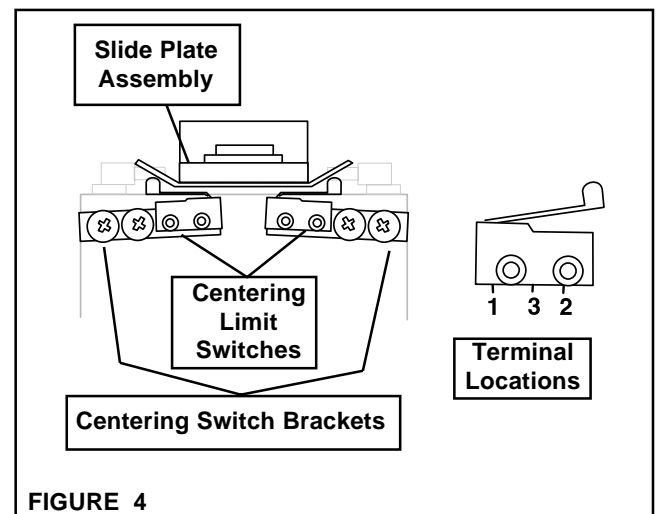

FIGURE 4

5. Loosen one Centering Switch Bracket and slide the Limit Switch and Centering Switch Bracket towards the middle of the unit until the ohmmeter reads 0 ohms.
  6. Slowly slide the Centering Switch Bracket in small increments in the opposite direction until the ohmmeter reads infinity (∞) or a high ohm reading.
  7. Tighten the Pan Head Screws holding the Centering Switch Bracket (See Figure 4).
  8. Repeat Steps 3 through 6 for the other Centering Limit Switch.
  9. Using an ohmmeter, recheck Terminals **1** and **3** of each Centering Limit Switch for a reading of infinity (∞) or a high ohm reading.
  10. Connect the Web Guide to the Controller.
- 

## REPLACEMENT PARTS

The item or balloon number for all Nexen products is used for part identification on all product parts list, product price list, unit assembly drawings, bills of materials, and instruction manuals.

When ordering replacement parts, specify model designation, item number, part description, and quantity. Purchase replacement parts through your local Nexen Distributor.

## PARTS LIST

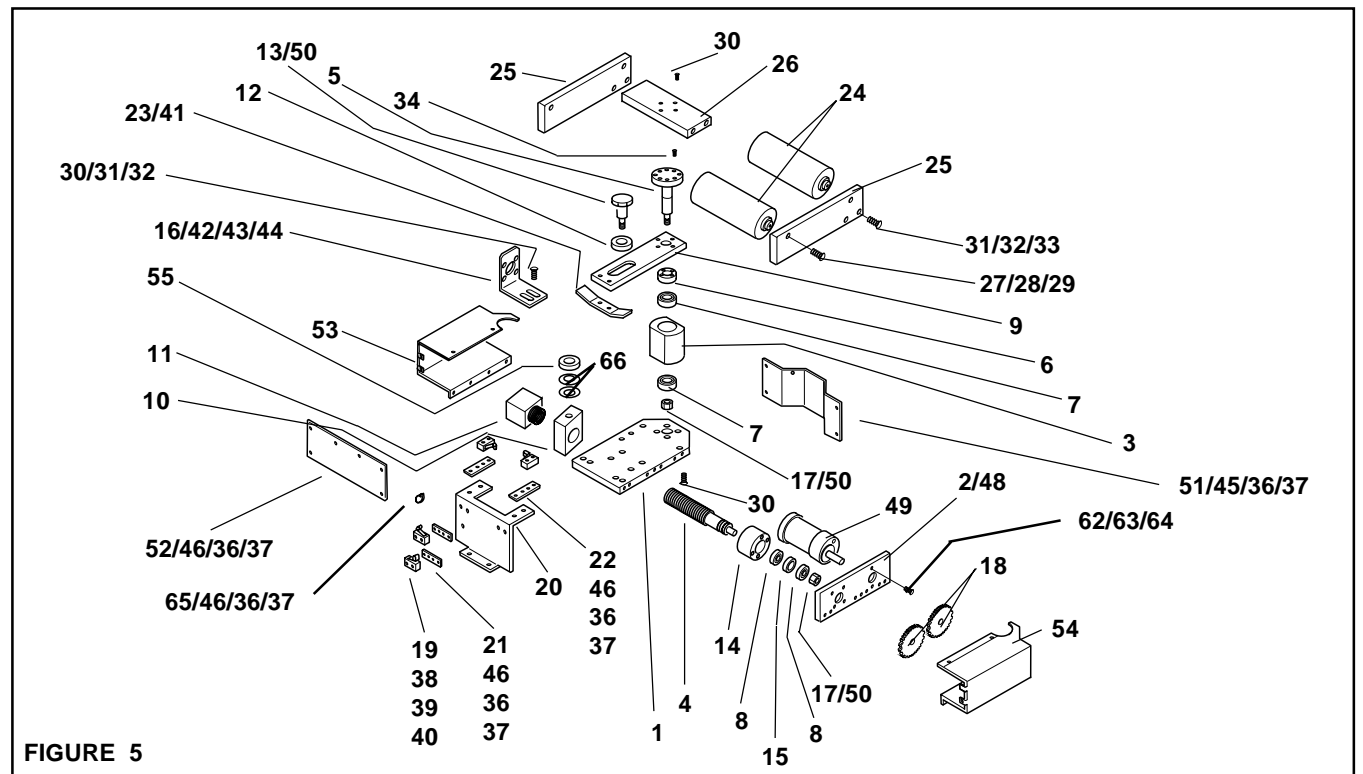

ITEM	DESCRIPTION	QTY
1	Base Plate	1
2	Side Plate	1
3	Pivot Base	1
4	Ball Screw	1
5	Pivot Screw	1
6	Pivot Spacer	1
7	Pivot Bearing	2
8	Motion Bearing	2
9	Slide Plate	1
10	Slide Mount	1
11	Ball Nut	1
12	Sleeve Screw	1
13	Motion Screw	1
14	Motion Housing	1
15	Bearing Spacer	1
16	Terminal Bracket	1
17	Pivot Shaft Nut	2
18	Spur Gear	2
19	Limit Switch	4
20	Sensor Mount	1
21	Centering Switch Bracket	2
22	Limit Switch Bracket	2
23	Centering Bracket	1
24	Idler Roll	2
25	Side Plate (Roller)	2
26	Roller Plate	1
27	Socket Head Cap Screw	4
28	Lock Washer (Not Shown)	4
29	Flat Washer (Not Shown)	4
30	Socket Head Cap Screw	10
31	Lock Washer (Not Shown)	6
32	Flat Washer (Not Shown)	6

ITEM	DESCRIPTION	QTY
33	Socket Head Cap Screw	4
34	Socket Head Cap Screw	4
36	Lock Washer (Not Shown)	29
37	Flat Washer (Not Shown)	29
38	Pan Head Screw	8
39	Flat Washer (Not Shown)	8
40	Lock Washer (Not Shown)	8
41	Flat Screw	2
42	Pan Head Screw	6
43	Lock Washer (Not Shown)	6
44	Flat Washer (Not Shown)	6
45	Pan Head Screw (Not Shown)	10
46	Pan Head Screw (Not Shown)	17
47	Socket Head Cap Screw	2
48	Socket Head Cap Screw	3
49	Motor Gearbox	1
50	Set Screw (Not Shown)	3
51	End Plate	1
52	End Plate	1
53	Cover (Left)	1
54	Cover (Right)	1
55	Spacer	1
56	Receptacle (Not Shown)	1
58	Contact Pin (Not Shown)	8
60	Cable (Not Shown)	1
61	Socket Head Cap Screw (Not Shown)	4
62	Socket Head Cap Screw	2
63	Lock Washer (Not Shown)	2
64	Flat Washer (Not Shown)	2
65	Cable Clamp	2
66	Belleville Washer	2

Note: Cable 30243 must be purchased separately.

## **WARRANTY**

Nexen Group, Inc. (Nexen) warrants its product(s) [the Product(s)] will be free from defects in materials and workmanship under normal use and service conditions for a period of 12 months from the date of shipment. NO OTHER WARRANTIES, WHETHER EXPRESS, IMPLIED, OR STATUTORY, INCLUDING WITHOUT LIMITATION WARRANTIES OF MERCHANTABILITY, OR OF FITNESS FOR A PARTICULAR PURPOSE, ARE GIVEN, AND ALL SUCH OTHER WARRANTIES ARE HEREBY EXPRESSLY DISCLAIMED.

### **Conditions**

This warranty applies only if: (a) the Product has been installed, used, and maintained in accordance with any applicable Nexen installation or maintenance manual for the Product; (b) the alleged defect is not attributable to normal wear and tear; (c) the Product has not been altered, misused, or used for purposes other than those for which it was intended; and (d) the claimant has complied with the warranty claim procedures set out below in Warranty Claim Procedures.

### **Exclusive Remedy**

The sole and exclusive remedy for a breach of this warrant shall be, at Nexen's sole election, repair or replacement with new, serviceably used or reconditioned Product, or issuance of a credit in the amount of the current Nexen discounted price for the Product.

### **Limitation of Damages**

In no event shall Nexen be liable for any consequential, indirect, incidental, or special damages of any nature whatsoever, including without limitation, lost profits arising from the sale or use of the Products.

### **Warranty Claim Procedures**

To make a claim under this warranty, the claimant must give written notice of the alleged defect to Nexen and deliver the Product to Nexen within one year of the date on which the alleged defect first became apparent.

**Nexen Group, Inc.**  
**560 Oak Grove Parkway**  
**Vadnais Heights, MN 55127**  
**800-843-7445**  
**In MN: (651) 484-5900**  
**Fax: (651) 286-1099**  
**[www.nexengroup.com](http://www.nexengroup.com)**

ISO 9001 Certified