



Large Web Guide

In accordance with Nexen's established policy of constant product improvement, the specifications contained in this manual are subject to change without notice. Technical data listed in this manual are based on the latest information available at the time of printing and are also subject to change without notice.

Technical Support: 800-843-7445
(651) 484-5900

www.nexengroup.com

Nexen Group, Inc.
560 Oak Grove Parkway
Vadnais Heights, Minnesota 55127

ISO 9001 Certified



WARNING

Read this manual carefully before installation and operation.

Follow Nexen's instructions and integrate this unit into your system with care.

This unit should be installed, operated and maintained by qualified personnel ONLY.

Improper installation can damage your system or cause injury or death.

Comply with all applicable codes.

Table of Contents

Installation -----	1
Electrical Connections -----	2
Limit Switch Adjustment -----	3
Replacement Parts -----	4
Parts List -----	4
Warranty -----	5

-NOTES-

INSTALLATION

GUIDE ROLL MECHANISM

1. Position the Web Guide as close as possible to the critical area to which the web is being guided. Any roll between the lead out roll **D** and the critical area will detract from guiding accuracy (See Figure 1).
2. Find the web path to be used (See Figure 1).
 - a. Lead in roll **B** and lead out roll **D** are customer provided.
 - b. The web must travel through the Web Guide in the direction of the arrow on the Roll Base of the Web Guide.
 - c. Web lead in distance (**B to A**) and lead out distance (**C to D**) must be at least equal to the web width.

NOTE

1 1/4 times the web width is the recommended distance between web lead in and lead out.

- d. Ensure that the Web Guide roll **A** and **C** are parallel to the web lead in roll **B** and the lead out roll **D** when the Web Guide is in its mid-travel or centered position.

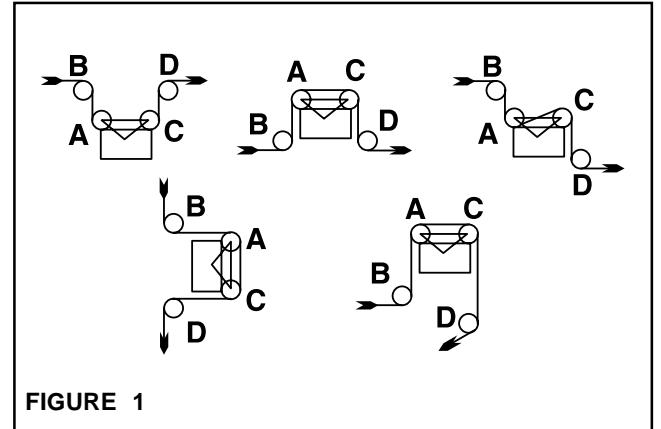

FIGURE 1

MOUNTING THE WEB GUIDE

Mount the Web Guide to the machine using the four M8 x 1.25 tapped mounting holes located on the underside of the Base (See Figure 2 and Table 1 for mounting dimensions).

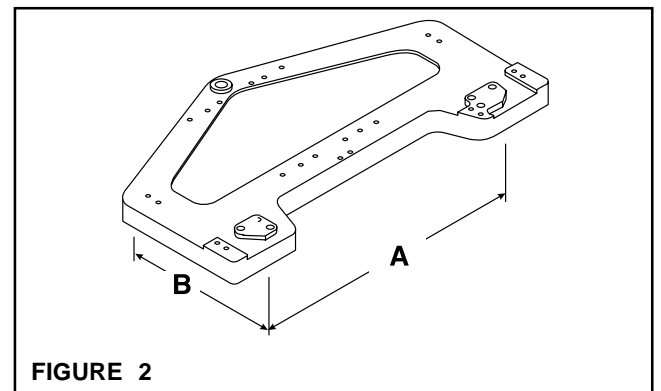

FIGURE 2

WEB GUIDE SIZE	A	B
18"	17.00"	7.50"
21"	15.75"	6.30"
24"	15.75"	6.30"
28"	27.00"	8.50"
32"	27.00"	9.50"

TABLE 1

ELECTRICAL CONNECTIONS

Nexen provides a cable compatible with the Large Web Guide to connect the web guide controller to the Web Guide. A cable makes the connections between the web guide controller and the Linear Actuator, Centering Switches, and Limit Switches. **P1** mates with connector **J1** mounted on the Web Guide (See Figures 3-6).

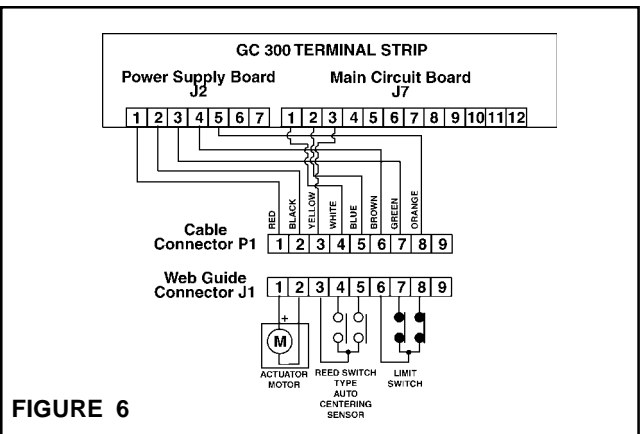
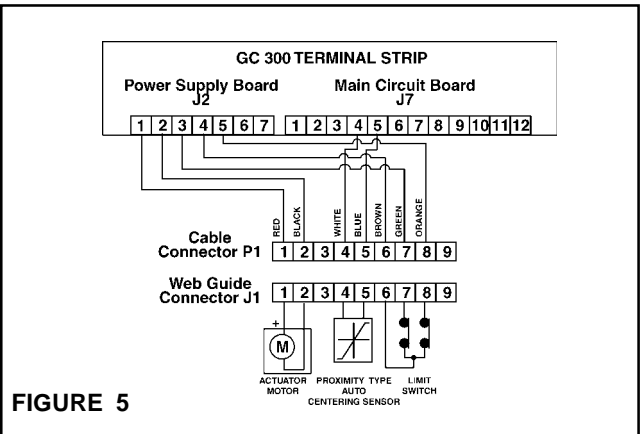
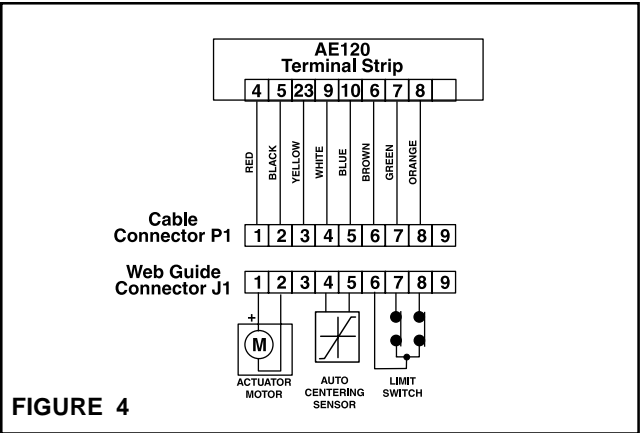
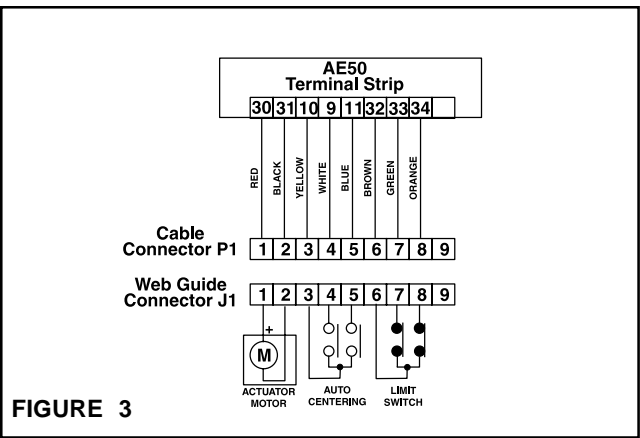

LIMIT SWITCH ADJUSTMENT

CAUTION

The Limit Switches have been set by Nexen for maximum travel. Limit Switches must be adjusted to interrupt movement before contact is made with a physical obstruction or stop. If there is no obstruction, the Limit Switches should remain in their factory set positions for maximum travel.

1. Loosen the Pan Head Screws holding the Limit Switch Brackets and slide the Limit Switch Brackets and Limit Switches to their fully extended positions (See Figure 7).
2. Turn "ON" the web guide controller and set it to the manual control mode.
3. Using the web guide controller's push buttons, rotate the web guide in one direction until the desired end of travel is reached (See Figure 8).
4. Connect a voltmeter across Terminals 1 and 2 of the Limit Switch (See Figure 7) that will limit the web guide movement in the direction just moved.
5. Slide the Limit Switch towards the Limit Switch Stop Plate until the Limit Switch is activated by the Limit Switch Stop Plate and the voltmeter reads ± 5 volts.
6. Tighten the Limit Switch Bracket's Pan Head Screws (See Figure 7).
7. Repeat Steps 3 through 6 for the second Limit Switch.
8. Turn the web guide controller "OFF".

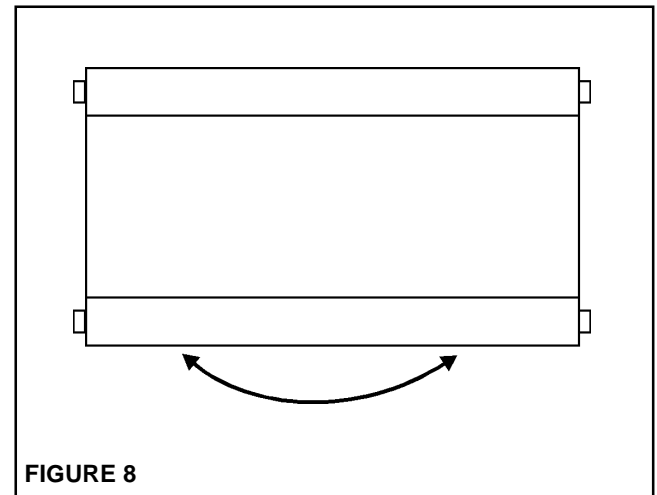
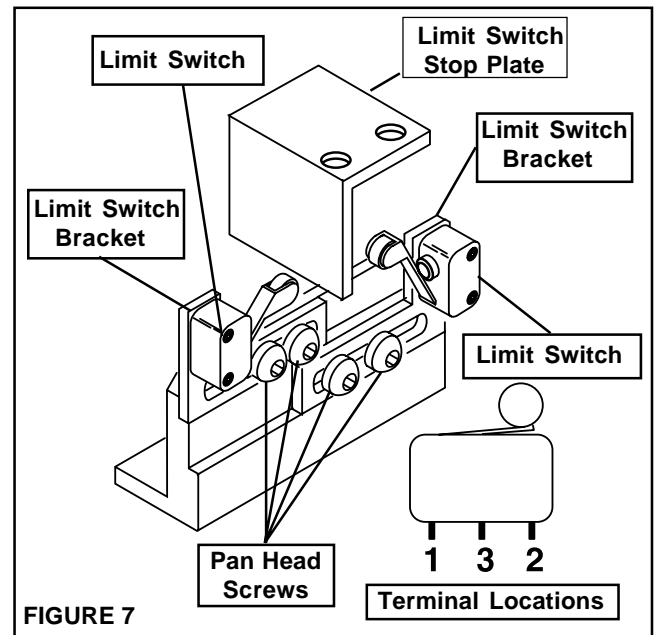

REPLACEMENT PARTS

The item or balloon number for all Nexen products is used for part identification on all product parts lists, product price lists, unit assembly drawings, bills of materials, and instruction manuals.

When ordering replacement parts, specify model designation, item number, part description, and quantity. Purchase replacement parts through your local Nexen Distributor.

PARTS LIST

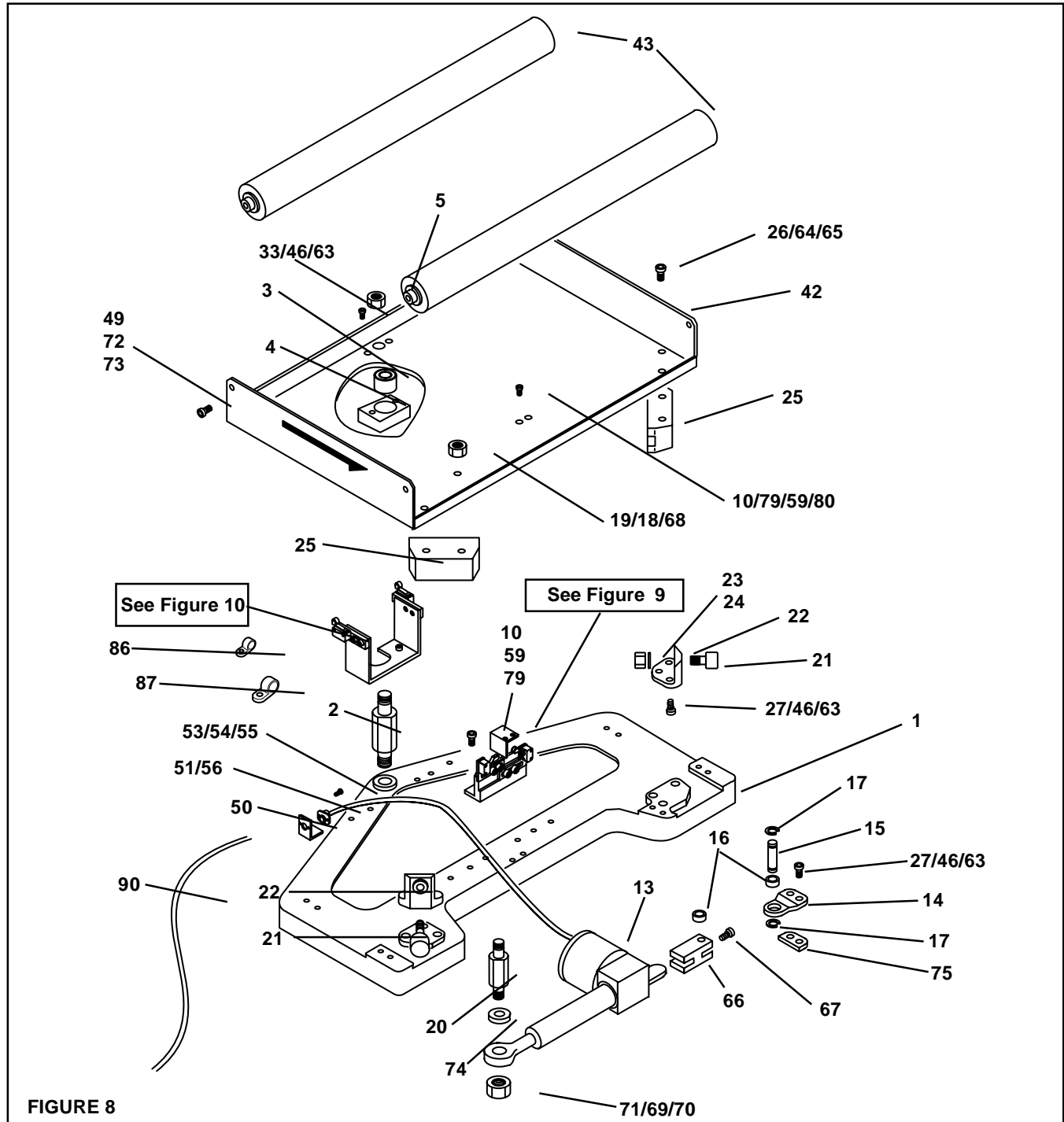

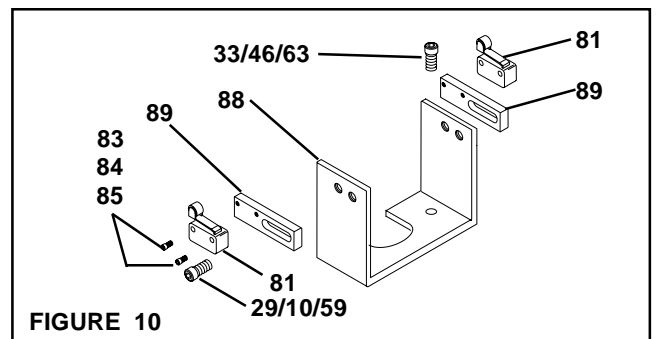
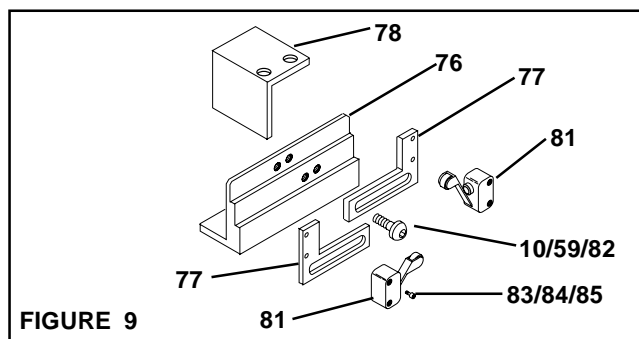

ITEM	DESCRIPTION	QTY
1	Base	1
2	Center Pivot Shaft	1
3	Angular Bearing	1 Set
4	Shaft Housing	1
5	Bearing Lock Nut	2
10	Flat Washer (Not Shown)	17
13	Linear Actuator	1
14	Actuator Bracket	1
15	Actuator Pivot Pin	1
16	Sleeve Bearing	3
17	Retaining Ring (Ext.)	2
18	Spring Lock Washer (Not Shown)	1
19	Hex. Nut	1
20	Actuator Pivot Shaft	1
21	Cam Follower Bearing	2
22	Bearing Stand	2
23	Spring Lock Washer	2
24	Hex. Nut	2
25	Bearing Guide Rail	2
26	Socket Head Cap Screw	4
27	Socket Head Cap Screw	8
29	Pan Head Screw	7
33	Socket Head Cap Screw	2
37	Socket Head Cap Screw	4
42	Roll Base	1
43	Roll	2
46	Flat Washer (Not Shown)	10
49	Socket Head Cap Screw	4
50	Bracket, Connector	1
51	Receptacle	1
53	Pan Head Screw	6
54	Spring Lock Washer (Not Shown)	6

ITEM	DESCRIPTION	QTY
55	Washer, Flat (Not Shown)	6
56	Cable, Clamp	1
58	Pin (Not Shown)	1
59	Spring Lock Washer (Not Shown)	15
63	Spring Lock Washer (Not Shown)	14
64	Flat Washer (Not Shown)	4
65	Spring Lock Washer (Not Shown)	4
66	Actuator Adapter Bracket	1
67	Socket Head Cap Screw	1
68	Flat Washer (Not Shown)	1
69	Spring Lock Washer (Not Shown)	1
70	Flat Washer (Not Shown)	1
71	Hex. Nut	1
72	Flat Washer (Not Shown)	4
73	Spring Lock Washer (Not Shown)	4
74	Actuator Spacer (18 Inch Only)	1
75	Actuator Bracket Spacer (18 Inch Only)	1
76	Adjustment Bracket	1
77	Limit Switch Mounting Bracket	2
78	Limit Switch Stop Plate	1
79	Pan Head Screw	4
80	Nut	2
81	Limit Switch	4
82	Pan Head Screw	4
83	Pan Head Screw	8
84	Washer (Not Shown)	8
85	Spring Lock Washer (Not Shown)	8
86	Cable Clamp	2
87	Cable Clamp	1
88	Bracket, Auto-Centering	1
89	Bracket, Limit Switch	2
90	Cable (Not Shown)	2

WARRANTY

Nexen Group, Inc. (Nexen) warrants its product(s) [the Product(s)] will be free from defects in materials and workmanship under normal use and service conditions for a period of 12 months from the date of shipment. NO OTHER WARRANTIES, WHETHER EXPRESS, IMPLIED, OR STATUTORY, INCLUDING WITHOUT LIMITATION WARRANTIES OF MERCHANTABILITY, OR OF FITNESS FOR A PARTICULAR PURPOSE, ARE GIVEN, AND ALL SUCH OTHER WARRANTIES ARE HEREBY EXPRESSLY DISCLAIMED.

Conditions

This warranty applies only if: (a) the Product has been installed, used, and maintained in accordance with any applicable Nexen installation or maintenance manual for the Product; (b) the alleged defect is not attributable to normal wear and tear; (c) the Product has not been altered, misused, or used for purposes other than those for which it was intended; and (d) the claimant has complied with the warranty claim procedures set out below in Warranty Claim Procedures.

Exclusive Remedy

The sole and exclusive remedy for a breach of this warrant shall be, at Nexen's sole election, repair or replacement with new, serviceably used or reconditioned Product, or issuance of a credit in the amount of the current Nexen discounted price for the Product.

Limitation of Damages

In no event shall Nexen be liable for any consequential, indirect, incidental, or special damages of any nature whatsoever, including without limitation, lost profits arising from the sale or use of the Products.

Warranty Claim Procedures

To make a claim under this warranty, the claimant must give written notice of the alleged defect to Nexen and deliver the Product to Nexen within one year of the date on which the alleged defect first became apparent.

nexen[™]

formerly Horton Industrial Products

Nexen Group, Inc.
560 Oak Grove Parkway
Vadnais Heights, MN 55127

800.843.7445
Fax: 651.286.1099
www.nexengroup.com

ISO 9001 Certified